

NOTICE!!

These documents have been scanned!

Do not place un-scanned documents beneath this notice!

Do not remove this notice from this file!

GPO Jacket No. 560-102
Print Order 61540
Rise Business Services, LLC
Job=AZ15 4/29/2019



Box Number= AZ15007



Claim Begin-End: AMC444579-AMC444584

1 Initial Receipt



AZ15007-12

AMC450400-AMC453366

United States Department of the Interior
Bureau of Land Management
 DIV OF LANDS, MINRLS & ENERGY
 ONE N CENTRAL AVE
 PHOENIX, AZ 85004 -4427
 Phone: 602-417-9200

Receipt

No: 3846112

Transaction #: 3954681	
Date of Transaction: 05/26/2017	
CUSTOMER:	
RON PARKER 14700 N SHOTGUN PL ORO VALLEY, AZ 85755-8811 US	

LINE #	QTY	DESCRIPTION	REMARKS	UNIT PRICE	TOTAL
1	6.00	LOCATABLE MINERALS / MINING CLAIMS-NEW, UNADJUD, ONE OR MORE AUTH NOS / NEW MINING CLAIM PROCESSING FEE CASES: AMC444579/\$20.00, AMC444580/\$20.00, AMC444581/\$20.00, AMC444582/\$20.00, AMC444583/\$20.00, AMC444584/\$20.00		- n/a -	120.00
2	6.00	LOCATABLE MINERALS / MINING CLAIMS-NEW, UNADJUD, ONE OR MORE AUTH NOS / NEW MINING CLAIMS LOCATION FEE CASES: AMC444579/\$37.00, AMC444580/\$37.00, AMC444581/\$37.00, AMC444582/\$37.00, AMC444583/\$37.00, AMC444584/\$37.00		- n/a -	222.00
3	6.00	LOCATABLE MINERALS / MINING CLAIMS-NEW, UNADJUD, ONE OR MORE AUTH NOS / NEW MINING CLAIMS MAINTENANCE FEE CASES: AMC444579/\$155.00, AMC444580/\$155.00, AMC444581/\$155.00, AMC444582/\$155.00, AMC444583/\$155.00, AMC444584/\$155.00		- n/a -	930.00
TOTAL:					\$1,272.00

PAYMENT INFORMATION			
1	AMOUNT:	1272.00	POSTMARKED: N/A
	TYPE:	CHECK	RECEIVED: 05/25/2017
	CHECK NO:	263	
	NAME:	PARKER, RON 14700 N SHOTGUN PL ORO VALLEY AZ 85755-8811 US	

REMARKS

This receipt was generated by the automated BLM Collections and Billing System and is a paper representation of a portion of the official electronic record contained therein.

NOTICE!!

These documents have been scanned!

Do not place un-scanned documents beneath this notice!

Do not remove this notice from this file!

GPO Jacket No. 560-102
Print Order 61540
Rise Business Services, LLC
Job=AZ15 4/29/2019



Box Number= AZ15007



Claim Begin-End: AMC444579-AMC444584

2 Correspondence



AZ15007-12

AMC450400-AMC453366

**NO
DOCUMENTS
FOUND**

NO DOCUMENTS FOUND
NO DOCUMENTS FOUND

NOTICE!!

These documents have been scanned!

Do not place un-scanned documents beneath this notice!

Do not remove this notice from this file!

GPO Jacket No. 560-102
Print Order 61540
Rise Business Services, LLC
Job=AZ15 4/29/2019



Box Number= AZ15007



Claim Begin-End: AMC444579-AMC444584

3 Transfers



AZ15007-12

AMC450400-AMC453366

**NO
DOCUMENTS
FOUND**

NO DOCUMENTS FOUND
NO DOCUMENTS FOUND

NOTICE!!

These documents have been scanned!

Do not place un-scanned documents beneath this notice!

Do not remove this notice from this file!

GPO Jacket No. 560-102
Print Order 61540
Rise Business Services, LLC
Job=AZ15 4/29/2019

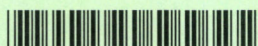

Box Number= AZ15007



Claim Begin-End: AMC444579-AMC444584

4 Annual Filings



AZ15007-12

AMC450400-AMC453366

LEAD Numbers

442462

445066

442458

443748

443752

433843

434009

433786

~~444579~~

445598

8/23/2018

LP Associates LLC

Loren Paripovich

808C 6th Ave NE

Buffalo, MN 55313

lorenparipovich@q.com

RECEIVED
BLM AZ STATE OFFICE
2018 AUG 27 P 2:48
PHOENIX, ARIZONA

Enclosed is a check for \$10,385 for 67 claims in the name of LP Associates LLC, to cover this year's Maintenance fees.

Thank you,

Loren Paripovich

612.812.3820



4247649

442462
445066

LP Associates LLC

8/23/2018

Loren Paripovich

ok AMC442462
ok AMC442463
ok AMC442464
ok AMC442465

ok AMC445066
ok AMC445067
ok AMC445068
ok AMC445069
ok AMC445070
ok AMC445071
ok AMC445072
ok AMC445073
ok AMC445074
ok AMC445075
ok AMC445076
ok AMC445077
ok AMC445078
ok AMC445079
ok AMC445080
ok AMC445081

RECEIVED
BLM AZ STATE OFFICE
2018 AUG 27 P 2:48
PHOENIX, ARIZONA

INTERED
AUG 30 2018
BY: SC 67
claims

442458
443748
443152

LP Associates LLC

8/23/2018

AMC442458
AMC442459
AMC442460
AMC442461

AMC443748
AMC443749
AMC443750
AMC443751
AMC443752
AMC443753
AMC443754
AMC443755
AMC443756
AMC443757
AMC443758
AMC443759
AMC443760
AMC443761
AMC443762
AMC443763

RECEIVED
BLM AZ STATE OFFICE
2018 AUG 27 P 2:48
PHOENIX, ARIZONA

ENTERED
AUG 30 2018
BY: SC

61 CLAIMS

LP Associates LLC

433843
434009
433786

8/23/2018

bl AMC433843

bl AMC434009

bl AMC434010

bl AMC433786

bl AMC433787

bl AMC433788

bl AMC433789

bl AMC433790

bl AMC433791

bl AMC433792

bl AMC433793

bl AMC433794

bl AMC433795

bl AMC433796

bl AMC433797

bl AMC433798

bl AMC433799

bl AMC433800

bl AMC433801

RECEIVED
BLM AZ STATE OFFICE
2018 AUG 27 P 2:48
PHOENIX, ARIZONA

ENTERED
AUG 30 2018
BY: SC

61 claims

444579
445598

LP Associates LLC

8/23/2018

~~WA~~ AMC444579

~~WA~~ AMC444580

~~WA~~ AMC444581

~~WA~~ AMC444582

~~WA~~ AMC444583

~~WA~~ AMC444584

~~WA~~ AMC445598

~~WA~~ AMC445599

RECEIVED
BLM AZ STATE OFFICE
2018 AUG 27 P 2:48
PHOENIX, ARIZONA

ENTERED
AUG 30 2018
BY: SC

bl claims

LP Associates
808C 6th Ave NE
Buffalo, MN 55313

RECEIVED
BLM AZ STATE OFFICE

2018 AUG 27 P 2:48

PHOENIX, ARIZONA

CERTIFIED MAIL



7016 0750 0000 3958 9659



1024



85004

U.S. POSTAGE
PAID
BUFFALO, MN
55313
AUG 22, 18
AMOUNT

\$3.95

R2304N118590-15

BUREAU of LAND Management - BLM
Division of Lands + Minerals
ONE N CENTRAL AVE
PHOENIX, AZ 85004-4427

850044427 0041

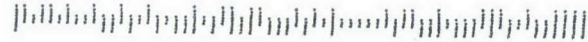

United States Department of the Interior
Bureau of Land Management
 DIV OF LANDS, MINRLS & ENERGY
 ONE N CENTRAL AVE
 PHOENIX, AZ 85004 -4427
 Phone: 602-417-9200

Receipt

No: 4247649

Transaction #: 4363121	
Date of Transaction: 08/28/2018	
CUSTOMER:	
LP ASSOCIATES LLC 808 6TH AVE NE APT C BUFFALO, MN 55313-1894 US	

LINE #	QTY	DESCRIPTION	REMARKS	UNIT PRICE	TOTAL
1	1.00	LOCATABLE MINERALS / MINING CLAIMS- NOT NEW-UNADJUD, ONE AUTH NO. ONLY / MINING CLAIM MONEY RECEIVED CASES: AMC442462/\$10385.00	MAINT 2019/67	- n/a -	10385.00
TOTAL:					\$10,385.00

PAYMENT INFORMATION			
1	AMOUNT:	10385.00	POSTMARKED: N/A
	TYPE:	CHECK	RECEIVED: 08/27/2018
	CHECK NO:	1572	
	NAME:	LP ASSOCIATES LLC 808 6TH AVE NE APT C BUFFALO MN 55313-1894 US	

REMARKS

This receipt was generated by the automated BLM Collections and Billing System and is a paper representation of a portion of the official electronic record contained therein.

LP Associates LLC
Loren Paripovich
808C 6th Ave NE
Buffalo, MN

612.812.3820

lorenparipovich@g.com

Enclosed is a check for \$10,075.00 for 65 claims in the name of LP Associates LLC.

433843

434009

433 786

444579

PHOENIX, ARIZONA

2017 AUG 28 P 3:48

RECEIVED
BLM AZ STATE OFFICE

442462

445066

442458

443748

443750

3944537

AT
9/1/17

LP Associates LLC
Loren Paripovich
808C 6th Ave NE
Buffalo, MN

612-812-3820
lorenparipovich@q.com

8-23-2017

AMC442462
AMC442463
AMC442464
AMC442465

AMC445066
AMC445067
AMC445068
AMC445069
AMC445070
AMC445071
AMC445072
AMC445073
AMC445074
AMC445075
AMC445076
AMC445077
AMC445078
AMC445079
AMC445080
AMC445081

RECEIVED
BLM AZ STATE OFFICE
2017 AUG 28 P 3:48
PHOENIX, ARIZONA

LP Associates LLC
Loren Paripovich
808C 6th Ave NE
Buffalo, MN 55313
AMC442458
AMC442459
AMC442460
AMC442461
AMC443748
AMC443749
AMC443750
AMC443751
AMC443752
AMC443753
AMC443754
AMC443755
AMC443756
AMC443757
AMC443758
AMC443759
AMC443760
AMC443761
AMC443762
AMC443763

612-812-3820
lorenparipovich@q.com

8-23-2017

RECEIVED
BLM AZ STATE OFFICE
2017 AUG 28 P 3:48
PHOENIX, ARIZONA

LP Associates LLC

Loren Paripovich

808C 6th Ave NE

Buffalo, MN 55313

612.812.3820

lorenparipovich@q.com

8-23-2017

AMC433843

AMC434009

AMC434010

AMC433786

AMC433787

AMC433788

AMC433789

AMC433790

AMC433791

AMC433792

AMC433793

AMC433794

AMC433795

AMC433796

AMC433797

AMC433798

AMC433799

AMC433800

AMC433801

RECEIVED
ELM A7 STATE OFFICE
2017 AUG 28 P 3:48
PHOENIX, ARIZONA

LP Associates LLC
Loren Paripovich
808C 6th Ave NE
Buffalo, MN 55313

612-812-3820
lorenparipovich@q.com

8-23-2017

AMC444579

AMC444580

AMC444581

AMC444582

AMC444583

AMC444584

RECEIVED
BLM ARIZONA STATE OFFICE
2017 AUG 28 P 3:48
PHOENIX, ARIZONA

**United States Department of the Interior
Bureau of Land Management**

DIV OF LANDS, MINRLS & ENERGY
ONE N CENTRAL AVE
PHOENIX, AZ 85004 -4427
Phone: 602-417-9200

Receipt

No: 3964537

Transaction #: 4074410	
Date of Transaction: 08/29/2017	
CUSTOMER:	
LP ASSOCIATES LLC 808 6TH AVE NE APT C BUFFALO, MN 55313-1894 US	

LINE #	QTY	DESCRIPTION	REMARKS	UNIT PRICE	TOTAL
1	1.00	LOCATABLE MINERALS / MINING CLAIMS- NOT NEW-UNADJUD, ONE AUTH NO. ONLY / MINING CLAIM MONEY RECEIVED CASES: AMC442462/\$10075.00	MAINT 2018/65	- n/a -	10075.00
TOTAL:					\$10,075.00

PAYMENT INFORMATION					
1	AMOUNT:	10075.00	POSTMARKED:	08/23/2017	
	TYPE:	CHECK	RECEIVED:	08/28/2017	
	CHECK NO:	1559			
	NAME:	LP ASSOCIATES LLC 808 6TH AVE NE APT C BUFFALO MN 55313-1894 US			

REMARKS

This receipt was generated by the automated BLM Collections and Billing System and is a paper representation of a portion of the official electronic record contained therein.

NOTICE!!

These documents have been scanned!

Do not place un-scanned documents beneath this notice!

Do not remove this notice from this file!

GPO Jacket No. 560-102
Print Order 61540
Rise Business Services, LLC
Job=AZ15 4/29/2019



Box Number= AZ15007



Claim Begin-End: AMC444579-AMC444584

5 Miscellaneous



AZ15007-12

AMC450400-AMC453366

United States Department of the Interior
Bureau of Land Management
 DIV OF LANDS, MINRLS & ENERGY
 ONE N CENTRAL AVE
 PHOENIX, AZ 85004 -4427
 Phone: 602-417-9200

Receipt

No: 4088771

Transaction #: 4200929	
Date of Transaction: 02/15/2018	
CUSTOMER:	
LP ASSOCIATES LLC 808 6TH AVE NE APT C BUFFALO, MN 55313-1894 US	

LINE #	QTY	DESCRIPTION	REMARKS	UNIT PRICE	TOTAL
1	1.00	LOCATABLE MINERALS / MINING CLAIMS- NOT NEW-UNADJUD, ONE AUTH NO. ONLY / MINING CLAIM MONEY RECEIVED CASES: AMC444579/\$60.00	TRF/6	- n/a -	60.00
TOTAL:					\$60.00

PAYMENT INFORMATION			
1	AMOUNT:	60.00	POSTMARKED: N/A
	TYPE:	CHECK	RECEIVED: 02/14/2018
	CHECK NO:	1010	
	NAME:	R & D ADVENTURES LLC ORO VALLEY AZ 85755 US	

REMARKS

This receipt was generated by the automated BLM Collections and Billing System and is a paper representation of a portion of the official electronic record contained therein.

*FOR AMENDMENTS ON AMC 444579-444584
 CORRECTING CLAIMANT NAME FROM LPA
 ASSOCIATES TO LP ASSOCIATES.
 635 ENTERED 2/14/2018. RL*

RON PARKER
14700 Shotgun Pl.
Oro Valley, AZ. 85737
(520) 825-5359
rocktoss@comcast.net

May 22, 2017

BLM

Please return the enclosed claim notices to:

Ron Parker
14700 N Shotgun Place
Oro Valley, AZ 85755

Thank you,

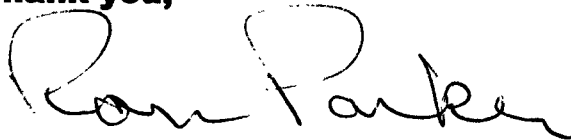
A handwritten signature in black ink that reads "Ron Parker". The signature is written in a cursive style with a large, looped initial "R".

2017 MAY 25 PM 2:52

NOTICE!!

These documents have been scanned!

Do not place un-scanned documents beneath this notice!

Do not remove this notice from this file!

GPO Jacket No. 560-102
Print Order 61540
Rise Business Services, LLC
Job=AZ15 4/29/2019



Box Number= AZ15007



Claim Begin-End: AMC444579-AMC444584

6 Location Notices-Amendments and Supporting Documents



AZ15007-12 AMC450400-AMC453366

MINING CLAIM STATUS REPORT

Data Entered: 6/5/17 RAM

MTP Checked By: 6/5/17 RAM
GEO Checked By: 6/5/17 RAM

LEAD SERIAL NUMBER: AMC 444579 thru AMC 444584

NUMBER OF CLAIMS & TYPE:

6 LODE
6 PLACER
ASSOCIATION PLACER
MILL SITE
TUNNEL SITE

CHARGES:

Processing Fee @ \$20 = \$ 120
Location Fee @ \$37 = \$ 222
Maintenance Fee @ \$155 = \$ 930
Add'l Maint Fee for Assoc Placer = \$
SUBTOTAL \$

TOTAL ACREAGE: _____ Per Claim
(Placer Only)

Other Fees \$
Other Fees \$

NUMBER OF LOCATORS: _____

TOTAL \$ 1,272

DOCUMENTS RECEIVED VIA: Over-the-Counter [] Mail **TIMELY FILED:** Yes No []

LEGAL DESCRIPTION: T 9S R 11E SEC 29, 30
T R SEC
T R SEC
T R SEC
T R SEC

BLM [] FOREST SERVICE [] SUBJ TO PL 359: Yes [] No []
WILDERNESS AREA []

SPLIT ESTATE: N/A [] SX [] PX [] OTHER []
SRHA [] Was proper Notice filed if located on SHRA Land? Yes [] No []

RECONVEYED MINERALS ON BLM LAND REQUIRE OPENING ORDER FROM 1944 TO 1993:
Open to Entry On _____ N/A []

COMMENTS/STATUS: VOID [] PARTIALLY VOID [] PVT MINERALS [] WITHDRAWN LANDS []
OTHER []

[] Claimant acknowledges that portions of the following claim(s) site(s) may be void or voidable.

Printed Name of Claimant _____ Signature of Claimant _____

*****FINAL ADJUDICATION*****

DATE 2/2/2018 INITIALS [Signature]

AMC444579

2

When recorded mail to:
Ron Parker
14700 N Shotgun Place
Oro Valley, AZ 85755



**OFFICIAL RECORDS OF
PINAL COUNTY RECORDER
VIRGINIA ROSS**

DATE/TIME: 01/26/2018 1126
FEE: \$10.00
PAGES: 2
FEE NUMBER: 2018-006092



(The above space reserved for recording information)

AMENDED LOCATION NOTICE FOR PLACER MINING CLAIM

DOCUMENT TITLE

*Fee #
2017-042867*

RECEIVED
2018 FEB 14 P 2:09
PHOENIX, ARIZONA

PM 04/14/18

DO NOT DISCARD THIS PAGE. THIS COVER PAGE IS RECORDED AS PART OF YOUR DOCUMENT. THE CERTIFICATE OF RECORDATION WITH THE FEE NUMBER IN THE UPPER RIGHT CORNER IS THE PERMANENT REFERENCE NUMBER OF THIS DOCUMENT IN THE PINAL COUNTY RECORDER'S OFFICE.

444579

Amended Placer Claim Notice AMC#444580

LOCATION NOTICE FOR PLACER MINING CLAIM

NOTICE IS HEREBY GIVEN that the LPA6-02 placer mining claim has been located by LP Associates, LLC whose current mailing address is 808 C 6th Ave. NE, Buffalo, MN. 55313.

BLM	PHOENIX, ARIZONA	2018 FEB 14 P 2:09	PROCESSED
DATE			
STAMP			

The general course of this claim is East to West and is situated in Pinal County, Arizona.

The claim is 1,320 feet in length and 660 feet in width. This claim runs from the location monument on which the location notice is posted (being the northeast corner of the said claim), approximately 660 feet in a southerly direction to the south end line and 1,320 feet in a westerly direction to the west end line.

The claim is marked by four 2"x2"x4' monuments, one at each corner of the claim.

The location monument on which this notice is posted is situated within Section 30, Township 9 South, Range 11 East, Gila Salt River Base and Meridian, Arizona. This claim encompasses portions of the following: N 1/2, SW 1/4, SE 1/4, Section 30, Township 9 South, Range 11 East.

Gila Salt River Base and Meridian, Arizona.

The locality of this claim with reference to some natural object or permanent monument and additional information (if any) concerning its locality are as follows: None

DATED AND POSTED on the ground this 20th day of May, 2017

Amended DATED AND POSTED on the ground this 13th day January, 2018.

LOCATOR (s) Owners

LP Associates, LLC

By 

Ron Parker/Agent for Owners

AMC 444579

LOCATION NOTICE FOR PLACER MINING CLAIM

NOTICE IS HEREBY GIVEN that the LPA6-02 placer mining claim has been located by LPA Associates, LLC whose current mailing address is 808 C 6th Ave. NE, Buffalo, MN. 55313.

BLM	
DATE	2017 MAY 25 P 2:52
STAMP	

The general course of this claim is East to West and is situated in Pinal County, Arizona.

The claim is 1,320 feet in length and 660 feet in width. This claim runs from the location monument on which the location notice is posted (being the northeast corner of the said claim), approximately 660 feet in a southerly direction to the south end line and 1,320 feet in a westerly direction to the west end line.

The claim is marked by four 2"x2"x4' monuments, one at each corner of the claim.

The location monument on which this notice is posted is situated within Section 30, Township 9 South, Range 11 East, Gila Salt River Base and Meridian, Arizona. This claim encompasses portions of the following: N 1/2, SW 1/4, SE 1/4, Section 30, Township 9 South, Range 11 East.

Gila Salt River Base and Meridian, Arizona.

The locality of this claim with reference to some natural object or permanent monument and additional information (if any) concerning its locality are as follows: None

DATED AND POSTED on the ground this 20th day of May, 2017

LOCATOR (s) Owners

LPA Associates, LLC

By *Ron Parker*

Ron Parker/Agent for Owners

AMC444579

Township 9 South, Range 11 East

Section 30

LPA6 claims Location

LPA6-02

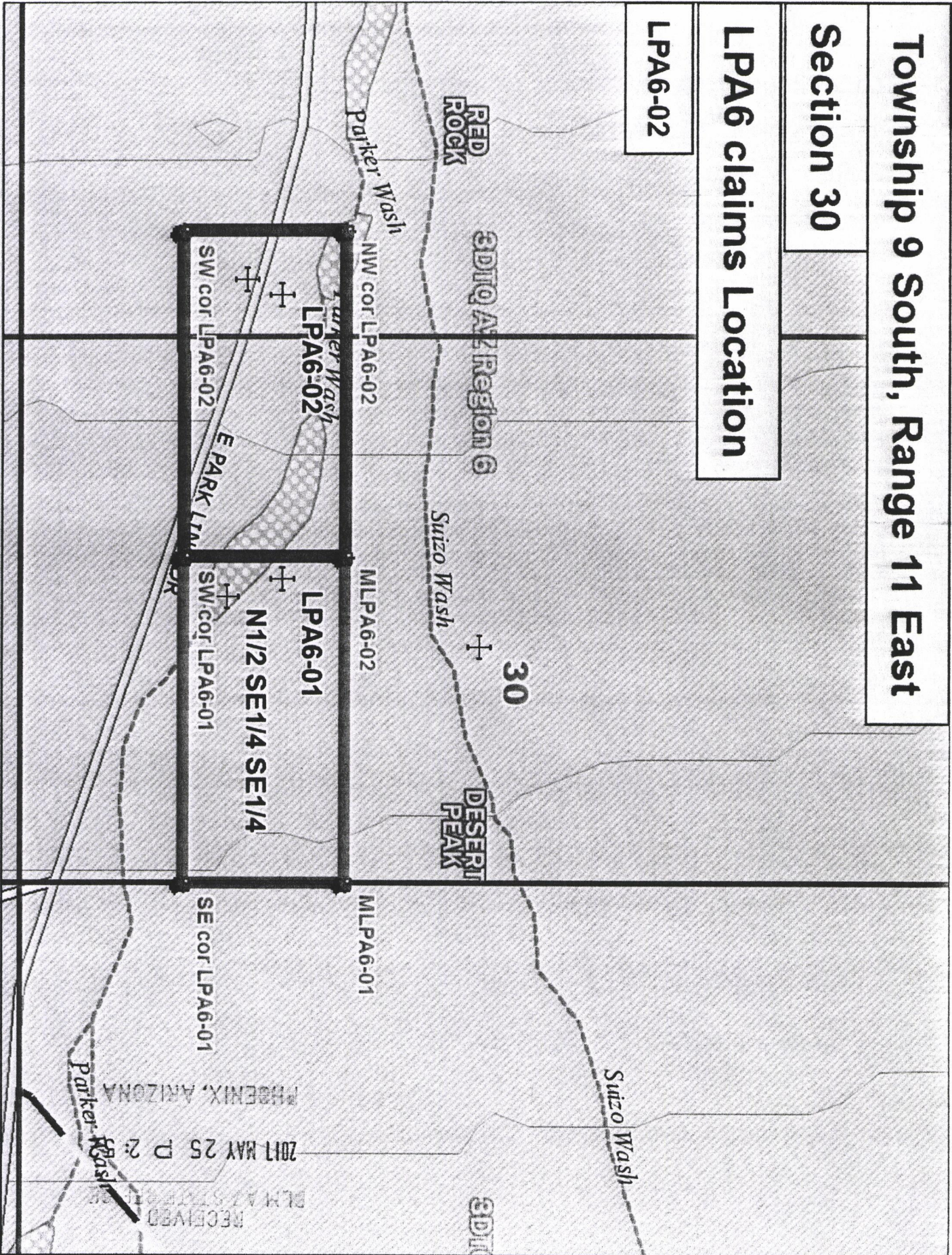

Data use subject to license.

© Delorme, Topo North America™ 10.

www.delorme.com

6 L 5 h h C M V

M11 (10 0° E)



Data Zoom 14-0

2



**OFFICIAL RECORDS OF
PINAL COUNTY RECORDER
VIRGINIA ROSS**

When recorded mail to:
Ron Parker
14700 N Shotgun Place
Oro Valley, AZ 85755

DATE/TIME: 01/26/2018 1126
FEE: \$10.00
PAGES: 2
FEE NUMBER: 2018-006091



(The above space reserved for recording information)

AMENDED LOCATION NOTICE FOR PLACER MINING CLAIM

DOCUMENT TITLE

Fee # 2017-042868

RECEIVED
2018 FEB 14 P 2:08
PHOENIX, ARIZONA

AMC 444580

DO NOT DISCARD THIS PAGE. THIS COVER PAGE IS RECORDED AS PART OF YOUR DOCUMENT. THE CERTIFICATE OF RECORDATION WITH THE FEE NUMBER IN THE UPPER RIGHT CORNER IS THE PERMANENT REFERENCE NUMBER OF THIS DOCUMENT IN THE PINAL COUNTY RECORDER'S OFFICE.

Amended Placer Claim Notice AMC#444579 ⁴⁴⁴⁵⁸⁰

LOCATION NOTICE FOR PLACER MINING CLAIM

NOTICE IS HEREBY GIVEN that the LPA6-01 placer mining claim has been located by LP Associates, LLC whose current mailing address is 808 C 6th Ave. NE, Buffalo, MN. 55313.

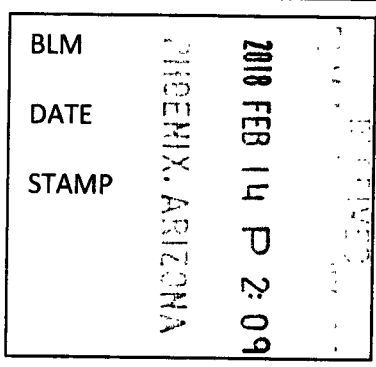

The general course of the claim is East to West and is situated in Pinal County, Arizona.

The claim is 1,320 feet in length and 660 feet in width. This claim runs from the location monument on which the location notice is posted (being the northeast corner of the said claim), approximately 660 feet in a southerly direction to the south end line and 1,320 feet in a westerly direction to the west end line.

The claim is marked by four 2"x2"x4' monuments, one at each corner of the claim.

The location monument on which this notice is posted is situated within Section 30, Township 9 South, Range 11 East, Gila Salt River Base and Meridian, Arizona. This claim encompasses portions of the following: N 1/2, SE 1/4, SE 1/4, Section 30, Township 9 South, Range 11 East.

Gila Salt River Base and Meridian, Arizona.

The locality of this claim with reference to some natural object or permanent monument and additional information (if any) concerning its locality are as follows: None

DATED AND POSTED on the ground this 20th day of May, 2017

Amended DATED AND POSTED on the ground this 13th day January, 2018.

LOCATOR (s) Owners

LP Associates, LLC

By *Ron Parker*

Ron Parker/Agent for Owners

AMC 444580

LOCATION NOTICE FOR PLACER MINING CLAIM

NOTICE IS HEREBY GIVEN that the LPA6-01 placer mining claim has been located by LPA Associates, LLC whose current mailing address is 808 C 6th Ave. NE, Buffalo, MN. 55313.

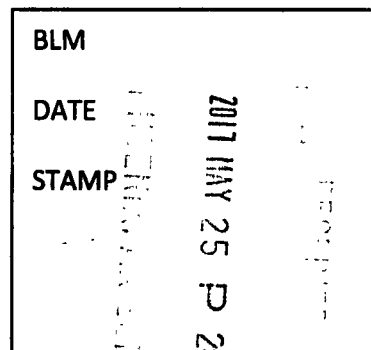

The general course of the claim is East to West and is situated in Pinal County, Arizona.

The claim is 1,320 feet in length and 660 feet in width. This claim runs from the location monument on which the location notice is posted (being the northeast corner of the said claim), approximately 660 feet in a southerly direction to the south end line and 1,320 feet in a westerly direction to the west end line.

The claim is marked by four 2"x2"x4' monuments, one at each corner of the claim.

The location monument on which this notice is posted is situated within Section 30, Township 9 South, Range 11 East, Gila Salt River Base and Meridian, Arizona. This claim encompasses portions of the following: N 1/2, SE 1/4, SE 1/4, Section 30, Township 9 South, Range 11 East.

Gila Salt River Base and Meridian, Arizona.

The locality of this claim with reference to some natural object or permanent monument and additional information (if any) concerning its locality are as follows: None

DATED AND POSTED on the ground this 20th day of May, 2017

LOCATOR (s) Owners

LPA Associates, LLC

By *Ron Parker*

Ron Parker/Agent for Owners

AMC444580

Township 9 South, Range 11 East

Section 30

3D110 A7 Section 6

LPA6 claims Location

LPA6-01

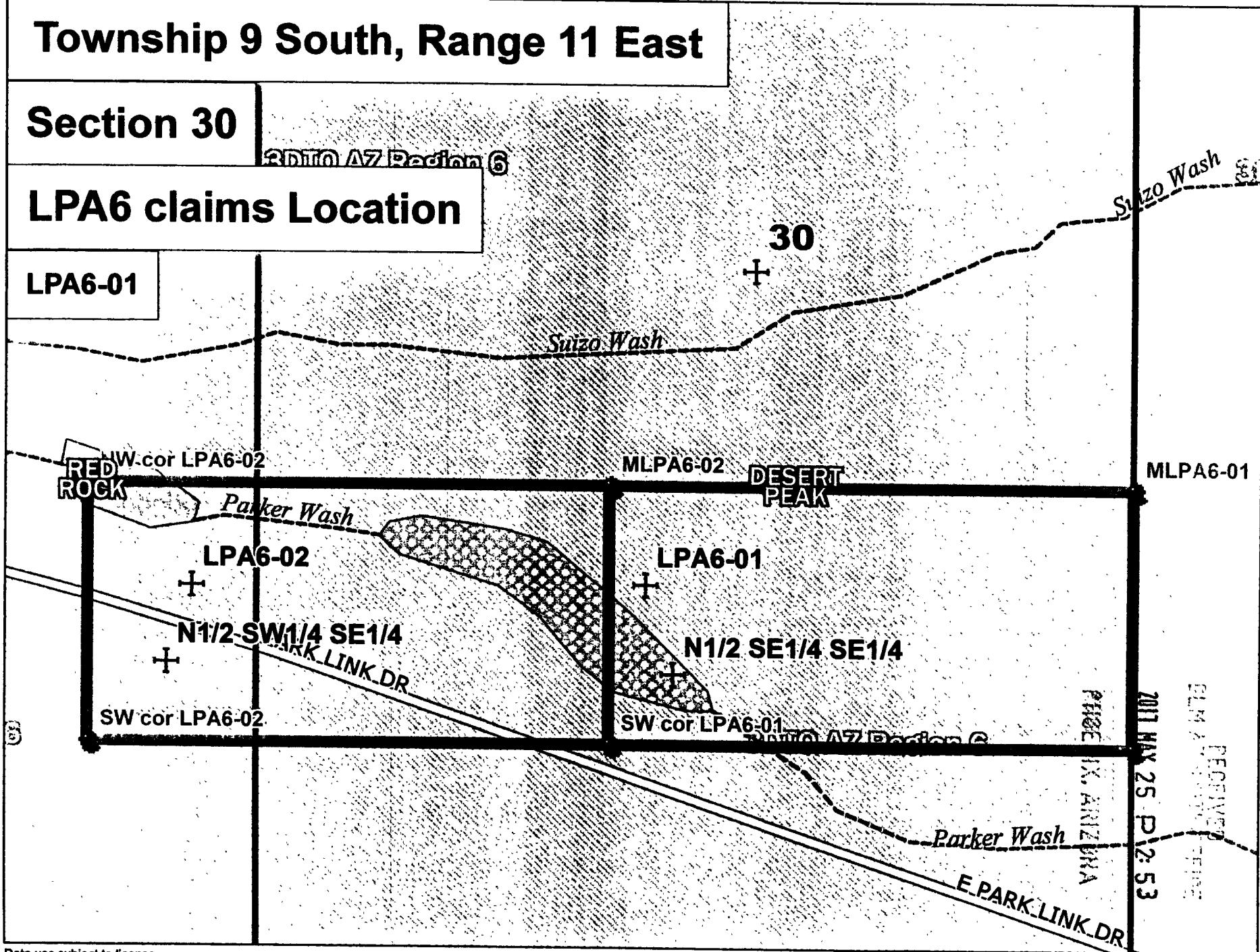

Data use subject to license.

© DeLorme. Topo North America™ 10.

www.delorme.com

AMCH4580

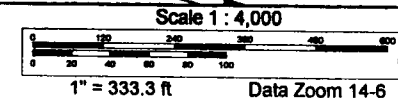

RECEIVED
 2011 MAR 25 P 2:53
 GEM & MINERAL
 PHOENIX, ARIZONA

2

When recorded mail to:
Ron Parker
14700 N Shotgun Place
Oro Valley, AZ 85755



**OFFICIAL RECORDS OF
PINAL COUNTY RECORDER
VIRGINIA ROSS**

DATE/TIME: 01/26/2018 1126
FEE: \$10.00
PAGES: 2
FEE NUMBER: 2018-006096



(The above space reserved for recording information)

AMENDED LOCATION NOTICE FOR PLACER MINING CLAIM

DOCUMENT TITLE

Fee #
2017-042869

RECEIVED
2018 FEB 14 P 2:09
PINAL COUNTY RECORDER
TUCSON, ARIZONA

Amc 444581

DO NOT DISCARD THIS PAGE. THIS COVER PAGE IS RECORDED AS PART OF YOUR DOCUMENT. THE CERTIFICATE OF RECORDATION WITH THE FEE NUMBER IN THE UPPER RIGHT CORNER IS THE PERMANENT REFERENCE NUMBER OF THIS DOCUMENT IN THE PINAL COUNTY RECORDER'S OFFICE.

Amended Placer Claim Notice AMC #444581

LOCATION NOTICE FOR PLACER MINING CLAIM

NOTICE IS HEREBY GIVEN that the LPA5-04 placer mining claim has been located by LP Associates, LLC whose current mailing address is 808 C 6th Ave. NE, Buffalo, MN. 55313.

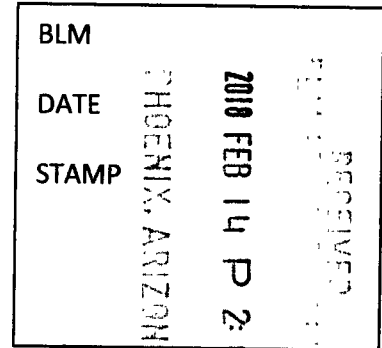

The general course of the claim is North to South and is situated in Pinal County, Arizona.

The claim is 1,320 feet in length and 660 feet in width. This claim runs from the location monument on which the location notice is posted (being the northeast corner of the said claim), approximately 1320 feet in a southerly direction to the south end line and 660 feet in a westerly direction to the west end line.

The claim is marked by four 2"x2"x4' monuments, one at each corner of the claim.

The location monument on which this notice is posted is situated within Section 29, Township 9 South, Range 11 East, Gila Salt River Base and Meridian, Arizona. This claim encompasses portions of the following: W 1/2, SW 1/4, SW 1/4, Section 29, Township 9 South, Range 11 East.

Gila Salt River Base and Meridian, Arizona.

The locality of this claim with reference to some natural object or permanent monument and additional information (if any) concerning its locality are as follows: None

DATED AND POSTED on the ground this 20th day of May, 2017
Amended DATED AND POSTED on the ground this 13th day of January, 2018

LOCATOR (s) Owners

LP Associates, LLC

By 

Ron Parker/Agent for Owners

AMC 444581

LOCATION NOTICE FOR PLACER MINING CLAIM

NOTICE IS HEREBY GIVEN that the LPA5-04 placer mining claim has been located by LPA Associates, LLC whose current mailing address is 808 C 6th Ave. NE, Buffalo, MN. 55313.

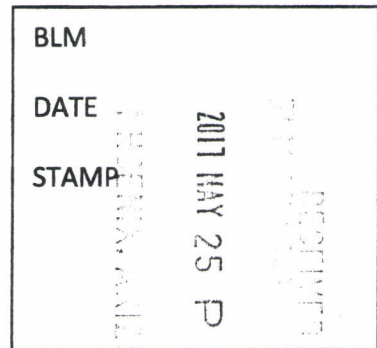

The general course of the claim is North to South and is situated in Pinal County, Arizona.

The claim is 1,320 feet in length and 660 feet in width. This claim runs from the location monument on which the location notice is posted (being the northeast corner of the said claim), approximately 1320 feet in a southerly direction to the south end line and 660 feet in a westerly direction to the west end line.

The claim is marked by four 2"x2"x4' monuments, one at each corner of the claim.

The location monument on which this notice is posted is situated within Section 29, Township 9 South, Range 11 East, Gila Salt River Base and Meridian, Arizona. This claim encompasses portions of the following: W 1/2, SW 1/4, SW 1/4, Section 29, Township 9 South, Range 11 East.

Gila Salt River Base and Meridian, Arizona.

The locality of this claim with reference to some natural object or permanent monument and additional information (if any) concerning its locality are as follows: None

DATED AND POSTED on the ground this 20th day of May, 2017

LOCATOR (s) Owners

LPA Associates, LLC

By 

Ron Parker/Agent for Owners

AMC444581

Township 9 South, Range 11 East

Section 29

LPA5 claims Location

LPA5-04

DURHAM HILLS

LPA5-01

29

W1/2 NW1/4 NW1/4

Region 6

3010 AZ Region

LPA5-02

W1/2 SW1/4 NW1/4

LPA5-03

W1/2 NW1/4 SW1/4

30

Sulzo Wash

Sulzo Wash

DESERT PEAK

LPA5-04

W1/2 SW1/4 SW1/4

E PARK LINK DR

Parker Wash

PHOENIX ARIZONA

JUL 25 P 2:58

RECEIVED

AMC44581

Data use subject to license.

© DeLorme. Topo North America™ 10.

www.delorme.com

11N (10.0° E)



Data Zoom 14-0

2

When recorded mail to:
Ron Parker
14700 N Shotgun Place
Oro Valley, AZ 85755



OFFICIAL RECORDS OF
PINAL COUNTY RECORDER
VIRGINIA ROSS

DATE/TIME: 01/26/2018 1126
FEE: \$10.00
PAGES: 2
FEE NUMBER: 2018-006095



(The above space reserved for recording information)

AMENDED LOCATION NOTICE FOR PLACER MINING CLAIM

DOCUMENT TITLE

Fee # 2017-642870

RECEIVED
2018 FEB 14 P 2:09
PHOENIX, ARIZONA

Amc 444582

DO NOT DISCARD THIS PAGE. THIS COVER PAGE IS RECORDED AS PART OF YOUR DOCUMENT. THE CERTIFICATE OF RECORDATION WITH THE FEE NUMBER IN THE UPPER RIGHT CORNER IS THE PERMANENT REFERENCE NUMBER OF THIS DOCUMENT IN THE PINAL COUNTY RECORDER'S OFFICE.

Amended Placer Claim Notice AMC #444582

LOCATION NOTICE FOR PLACER MINING CLAIM

NOTICE IS HEREBY GIVEN that the LPA5-03 placer mining claim has been located by LP Associates, LLC whose current mailing address is 808 C 6th Ave. NE, Buffalo, MN. 55313.

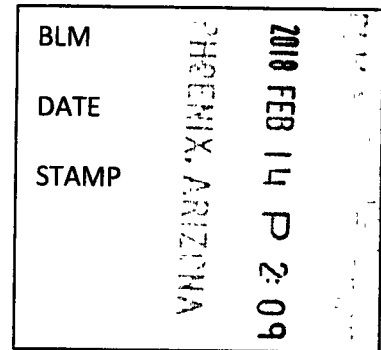

The general course of the claim is North to South and is situated in Pinal County, Arizona.

The claim is 1,320 feet in length and 660 feet in width. This claim runs from the location monument on which the location notice is posted (being the northeast corner of the said claim), approximately 1320 feet in a southerly direction to the south end line and 660 feet in a westerly direction to the west end line.

The claim is marked by four 2"x2"x4' monuments, one at each corner of the claim.

The location monument on which this notice is posted is situated within Section 29, Township 9 South, Range 11 East, Gila Salt River Base and Meridian, Arizona. This claim encompasses portions of the following: W 1/2, NW 1/4, SW 1/4, Section 29, Township 9 South, Range 11 East.

Gila Salt River Base and Meridian, Arizona.

The locality of this claim with reference to some natural object or permanent monument and additional information (if any) concerning its locality are as follows: None

DATED AND POSTED on the ground this 20th day of May, 2017
Amended DATED AND POSTED on the ground this 13th day of January, 2018

LOCATOR (s) Owners

LP Associates, LLC

By 

Ron Parker/Agent for Owners

AMC 444582

LOCATION NOTICE FOR PLACER MINING CLAIM

NOTICE IS HEREBY GIVEN that the LPA5-03 placer mining claim has been located by LPA Associates, LLC whose current mailing address is 808 C 6th Ave. NE, Buffalo, MN. 55313.

BLM	
DATE	2011 MAY 25 P 2 53
STAMP	

The general course of the claim is North to South and is situated in Pinal County, Arizona.

The claim is 1,320 feet in length and 660 feet in width. This claim runs from the location monument on which the location notice is posted (being the northeast corner of the said claim), approximately 1320 feet in a southerly direction to the south end line and 660 feet in a westerly direction to the west end line.

The claim is marked by four 2"x2"x4' monuments, one at each corner of the claim.

The location monument on which this notice is posted is situated within Section 29, Township 9 South, Range 11 East, Gila Salt River Base and Meridian, Arizona. This claim encompasses portions of the following: W 1/2, NW 1/4, SW 1/4, Section 29, Township 9 South, Range 11 East.

Gila Salt River Base and Meridian, Arizona.

The locality of this claim with reference to some natural object or permanent monument and additional information (if any) concerning its locality are as follows: None

DATED AND POSTED on the ground this 20th day of May, 2017

LOCATOR (s) Owners

LPA Associates, LLC

By 

Ron Parker/Agent for Owners

AMC444582

Township 9 South, Range 11 East

Section 29

LPA5 claims Location

LPA5-03

DURHAM HILLS

LPA5-01

29

W1/2 NW1/4 NW1/4

Region 6

3D10 AZ REGION

LPA5-02

W1/2 SW1/4 NW1/4

LPA5-03

W1/2 NW1/4 SW1/4

30

3D10 AZ REGION

DESERT PEAK

Sulzo Wash

Sulzo Wash

LPA5-04

W1/2 SW1/4 SW1/4

E PARK LINK DR

Parker IV

2011 MAR 25 P 2

RECEIVED

AMC444582

Data use subject to license.

© DeLorme. Topo North America™ 10.

www.delorme.com



1:10,000 (10.0° E)

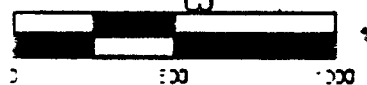

Data Zoom 14-0

2



**OFFICIAL RECORDS OF
PINAL COUNTY RECORDER
VIRGINIA ROSS**

When recorded mail to:
Ron Parker
14700 N Shotgun Place
Oro Valley, AZ 85755

DATE/TIME: 01/26/2018 1126
FEE: \$10.00
PAGES: 2
FEE NUMBER: 2018-006094



(The above space reserved for recording information)

AMENDED LOCATION NOTICE FOR PLACER MINING CLAIM

DOCUMENT TITLE

Fee #
2017-042871

RECEIVED
2018 FEB 14 P 2:09
PHOENIX, ARIZONA

AMC 444583

DO NOT DISCARD THIS PAGE. THIS COVER PAGE IS RECORDED AS PART OF YOUR DOCUMENT. THE CERTIFICATE OF RECORDATION WITH THE FEE NUMBER IN THE UPPER RIGHT CORNER IS THE PERMANENT REFERENCE NUMBER OF THIS DOCUMENT IN THE PINAL COUNTY RECORDER'S OFFICE.

Amended Placer Claim Notice AMC #444583

LOCATION NOTICE FOR PLACER MINING CLAIM

NOTICE IS HEREBY GIVEN that the LPA5-02 placer mining claim has been located by LP Associates, LLC whose current mailing address is 808 C 6th Ave. NE, Buffalo, MN. 55313.

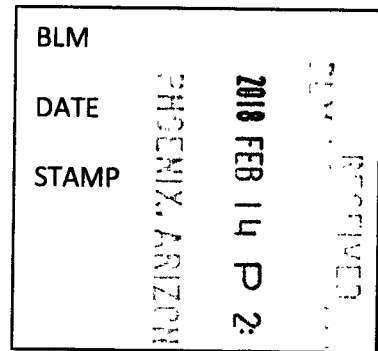

The general course of the claim is North to South and is situated in Pinal County, Arizona.

The claim is 1,320 feet in length and 660 feet in width. This claim runs from the location monument on which the location notice is posted (being the northeast corner of the said claim), approximately 1320 feet in a southerly direction to the south end line and 660 feet in a westerly direction to the west end line.

The claim is marked by four 2"x2"x4' monuments, one at each corner of the claim.

The location monument on which this notice is posted is situated within Section 29, Township 9 South, Range 11 East, Gila Salt River Base and Meridian, Arizona. This claim encompasses portions of the following: W 1/2, SW 1/4, NW 1/4, Section 29, Township 9 South, Range 11 East.

Gila Salt River Base and Meridian, Arizona.

The locality of this claim with reference to some natural object or permanent monument and additional information (if any) concerning its locality are as follows: None

DATED AND POSTED on the ground this 20th day of May, 2017
Amended DATED AND POSTED on the ground this 13th day of January, 2018

LOCATOR (s) Owners

LP Associates, LLC

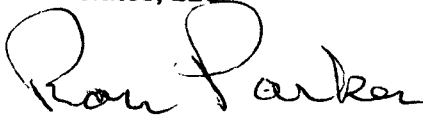
By 

Ron Parker/Agent for Owners

AMC 444583

LOCATION NOTICE FOR PLACER MINING CLAIM

NOTICE IS HEREBY GIVEN that the LPA5-02 placer mining claim has been located by LPA Associates, LLC whose current mailing address is 808 C 6th Ave. NE, Buffalo, MN. 55313.

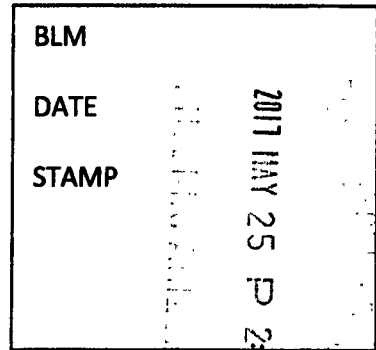

The general course of the claim is North to South and is situated in Pinal County, Arizona.

The claim is 1,320 feet in length and 660 feet in width. This claim runs from the location monument on which the location notice is posted (being the northeast corner of the said claim), approximately 1320 feet in a southerly direction to the south end line and 660 feet in a westerly direction to the west end line.

The claim is marked by four 2"x2"x4' monuments, one at each corner of the claim.

The location monument on which this notice is posted is situated within Section 29, Township 9 South, Range 11 East, Gila Salt River Base and Meridian, Arizona. This claim encompasses portions of the following: W 1/2, SW 1/4, NW 1/4, Section 29, Township 9 South, Range 11 East.

Gila Salt River Base and Meridian, Arizona.

The locality of this claim with reference to some natural object or permanent monument and additional information (if any) concerning its locality are as follows: None

DATED AND POSTED on the ground this 20th day of May, 2017

LOCATOR (s) Owners

LPA Associates, LLC

By 

Ron Parker/Agent for Owners

AMC444583

Township 9 South, Range 11 East

Section 29

LPA5 claims Location

LPA5-02

DURHAM HILLS

LPA5-01

29

W1/2 NW1/4 NW1/4

Region 6

3D TO AZ Region

LPA5-02

W1/2 SW1/4 NW1/4

LPA5-03

W1/2 NW1/4 SW1/4

30

3D TO AZ Region

DESERT PEAK

Silzo Wash

Silzo Wash

LPA5-04

W1/2 SW1/4 SW1/4

E PARK LINK DR

Parker Wash

2017 MAY 25 P 2:53

RECEIVED

AMC44583

Data use subject to license.

© DeLorme. Topo North America™ 10.

www.delorme.com



11N (10.0° E)

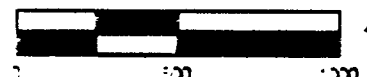

Data Zoom 14-0

2

When recorded mail to:
Ron Parker
14700 N Shotgun Place
Oro Valley, AZ 85755



**OFFICIAL RECORDS OF
PINAL COUNTY RECORDER
VIRGINIA ROSS**

DATE/TIME: 01/26/2018 1126
FEE: \$10.00
PAGES: 2
FEE NUMBER: 2018-006093



(The above space reserved for recording information)

AMENDED LOCATION NOTICE FOR PLACER MINING CLAIM

DOCUMENT TITLE

*Fee #
2017-042872*

RECEIVED
2018 FEB 14 P 2:09
PHOENIX, ARIZONA

Amc 444584

DO NOT DISCARD THIS PAGE. THIS COVER PAGE IS RECORDED AS PART OF YOUR DOCUMENT. THE CERTIFICATE OF RECORDATION WITH THE FEE NUMBER IN THE UPPER RIGHT CORNER IS THE PERMANENT REFERENCE NUMBER OF THIS DOCUMENT IN THE PINAL COUNTY RECORDER'S OFFICE.

Amended Placer Claim Notice AMC #444584

LOCATION NOTICE FOR PLACER MINING CLAIM

NOTICE IS HEREBY GIVEN that the LPA5-01 placer mining claim has been located by LP Associates, LLC whose current mailing address is 808 C 6th Ave. NE, Buffalo, MN. 55313.

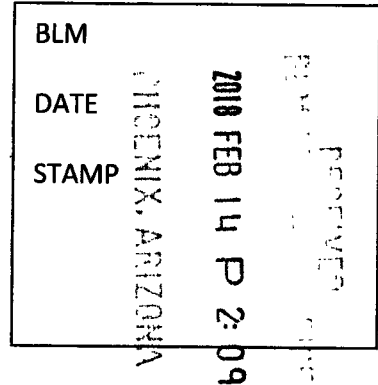

The general course of the claim is North to South and is situated in Pinal County, Arizona.

The claim is 1,320 feet in length and 660 feet in width. This claim runs from the location monument on which the location notice is posted (being the northeast corner of the said claim), approximately 1320 feet in a southerly direction to the south end line and 660 feet in a westerly direction to the west end line.

The claim is marked by four 2"x2"x4' monuments, one at each corner of the claim.

The location monument on which this notice is posted is situated within Section 29, Township 9 South, Range 11 East, Gila Salt River Base and Meridian, Arizona. This claim encompasses portions of the following: W 1/2, NW 1/4, NW 1/4, Section 29, Township 9 South, Range 11 East.

Gila Salt River Base and Meridian, Arizona.

The locality of this claim with reference to some natural object or permanent monument and additional information (if any) concerning its locality are as follows: None

DATED AND POSTED on the ground this 20th day of May, 2017
Amended DATED AND POSTED on the ground this 13th day of January, 2018

LOCATOR (s) Owners

LP Associates, LLC

By

Ron Parker/Agent for Owners

AMC 444584

LOCATION NOTICE FOR PLACER MINING CLAIM

NOTICE IS HEREBY GIVEN that the LPA5-01 placer mining claim has been located by LPA Associates, LLC whose current mailing address is 808 C 6th Ave. NE, Buffalo, MN. 55313.

BLM
DATE
STAMP

2017 MAY 25 10 26 53
FEDERAL BUREAU OF SURVEY

The general course of the claim is North to South and is situated in Pinal County, Arizona

The claim is 1,320 feet in length and 660 feet in width. This claim runs from the location monument on which the location notice is posted (being the northeast corner of the said claim), approximately 1320 feet in a southerly direction to the south end line and 660 feet in a westerly direction to the west end line.

The claim is marked by four 2"x2"x4' monuments, one at each corner of the claim.

The location monument on which this notice is posted is situated within Section 29, Township 9 South, Range 11 East, Gila Salt River Base and Meridian, Arizona. This claim encompasses portions of the following: W 1/2, NW 1/4, NW 1/4, Section 29, Township 9 South, Range 11 East.

Gila Salt River Base and Meridian, Arizona.

The locality of this claim with reference to some natural object or permanent monument and additional information (if any) concerning its locality are as follows: None

DATED AND POSTED on the ground this 20th day of May, 2017

LOCATOR (s) Owners

LPA Associates, LLC

By 

Ron Parker/Agent for Owners

A M C 4 4 4 5 8 4

Township 9 South, Range 11 East

Section 29

LPA5 claims Location

LPA5-01

DURHAM HILLS

LPA5-01

29

W1/2 NW1/4 NW1/4

Region 6

EDTO AZ Region

LPA5-02

W1/2 SW1/4 NW1/4

LPA5-03

W1/2 NW1/4 SW1/4

30

Sulzo Wash

LPA5-04

W1/2 SW1/4 SW1/4

E PARK LINK DR

Parker Wash

2011 MAR 25 P 2:51

RECEIVED

AN044584

Data use subject to license.

© DeLorme. Topo North America™ 10.

www.delorme.com



1:IN (10.0° E)

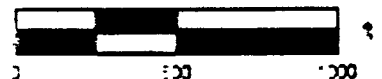

Data Zoom 14-0

Input Parameters for Geographic Report with Land

System Id = CR

Admin State = AZ

Geo State =

Casetype Begins With

Case Disp Txt = AUTHORIZED, CANCELLED, EXPIRED, PENDING, REJECTED, RELINQUISHED, WITHDRAWN

Mer Twp Rng =

Section =

Mtrs = 14 0090S 0110E 029, 14 0090S 0110E 030, 14 0090S 0110E 999

Commodity =

Commodity Txt =

Pending Org =

Pend Org Decode =

Total Rows Returned: 3

RUN TIME: 12:26 PM

UNITED STATES DEPARTMENT OF INTERIOR
BUREAU OF LAND MANAGEMENT
GEOGRAPHIC REPORT WITH LAND
Sorted by Serial Number

RUN DATE: 06/05/2017
Page 1 of 1

Serial Number: AZA 021398
Total Case Acres: 75.760

<u>Casetype</u>	<u>Case Disp</u>	14	0090S	0110E	<u>Sect</u>	<u>Sur Typ</u>	<u>Sur Num</u>	<u>Suff</u>	<u>Subdivision</u>	<u>Act Pend</u>
282201	AUTHORIZED				029	ALIQ			S2;	
					030	ALIQ			E2SW,SE;	
						LOTS			3,4;	

Serial Number: AZA 035058
Total Case Acres: 6.121

<u>Casetype</u>	<u>Case Disp</u>	14	0090S	0110E	<u>Sect</u>	<u>Sur Typ</u>	<u>Sur Num</u>	<u>Suff</u>	<u>Subdivision</u>	<u>Act Pend</u>
285003	PENDING				030	ALIQ			SESW,S2SE;	Y
						LOTS			1-4;	Y

Parker
14700 North Shotgun Pl
Oro Valley, AZ 85955



1013



85004

U.S. POSTAGE
PAID
TUCSON, AZ
85737
MAY 23, 17
AMOUNT

\$1.40

R2304M110067-22

Bureau of Land Management
One North Central Ave.
Suite 800
Phoenix, AZ 85004-4427

PHOENIX, ARIZONA

2017 MAY 25 P 2:52

FLM, RECEIVED

